

Pg 101

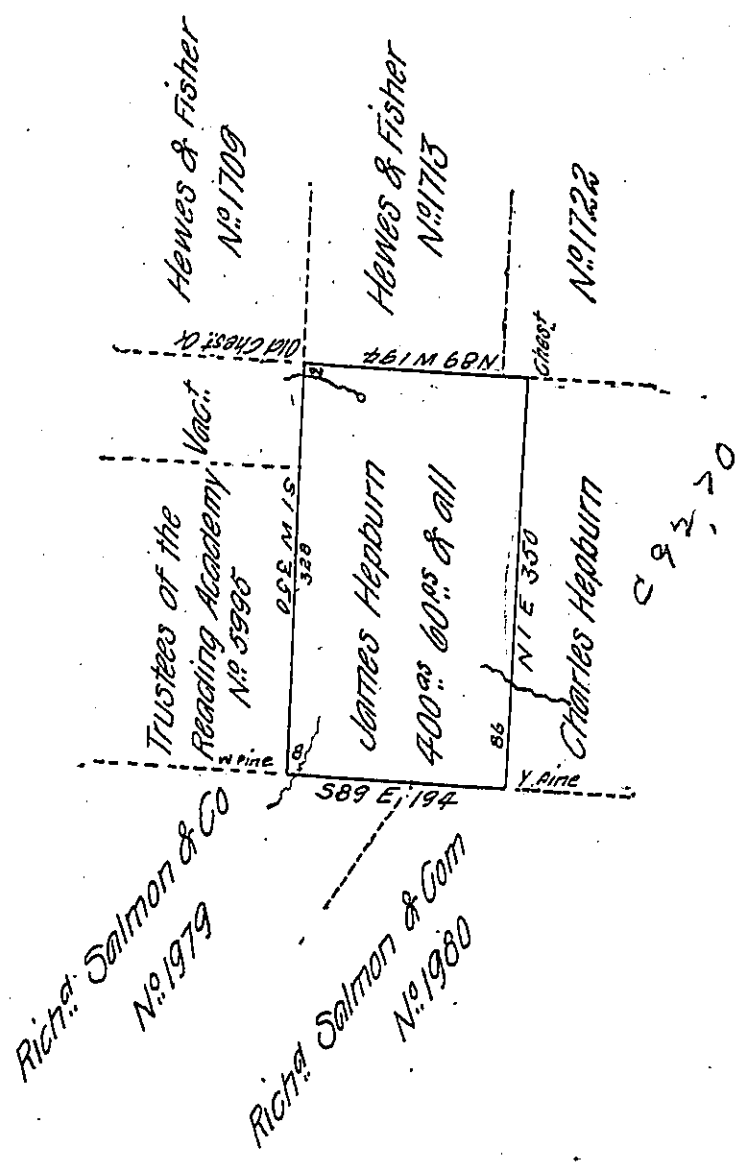

Situate in Cuming's Township County of Lycoming on the waters of the first fork of Pine Creek and first fork of Larrys Creek and bounded as above described Surveyed to James Hepburn on the on the 22<sup>nd</sup> day of October 1839 by virtue of his warrant for 400 acres dated the 17<sup>th</sup> day of August 1830 Containing four hundred acres and sixty perches with allowance of six per cent for roads &c

To Jacob Gallade Esquire }  
Surveyor General

Alexander H. McHenry D. S.

P. S. The above survey could not join James Hepburn & Co in consequence of their (James Hepburn & Co.) interfering with surveys of an earlier date on the side it was expected to join

Approved this day May 19<sup>th</sup> 1847

A. H. McHenry D. S.

Fr. S. Riddle D. S.

IN TESTIMONY that the above is a copy of the original remaining on file in the Department of Internal Affairs of Pennsylvania, made conformably to an Act of Assembly approved the 16th day of February, 1833, I have hereunto set my Hand and caused the Seal of said Department to be affixed at Harrisburg, this third day of June 1905

*Joseph B. Brown*  
Secretary of Internal Affairs.